

The SAT and SAT Subject Tests

Registration Quick Guide

Registration Requirements

When you register for the SAT® or SAT Subject Tests™, you'll need to supply:

- 1 Your full legal name as it appears on your photo ID, your date of birth, gender, mailing address, and current grade level.
- 2 An acceptable photo of yourself that closely resembles the photo on your ID and that will match how you look on test day. See more below.
- 3 Your high school code. Find this at collegeboard.org/sat-codes, or ask your school counselor.
- 4 The test type (SAT, SAT with Essay, or SAT Subject Tests), the test date, and the test center you're choosing.
- 5 Acceptance of our Terms and Conditions, either online or by completing and signing the paper registration form.
- 6 Payment or a fee waiver.

Photo Requirements

You must submit a photo when you register. Make sure your photo meets these requirements:

- You're easy to recognize.
- You're the only one in the picture.
- It shows a head-and-shoulders view, with the entire face, both eyes, and hair clearly visible; head coverings worn for religious purposes are allowed.
- You're in focus, and there are no dark spots or shadows.

Visit sat.org/photo for more information.

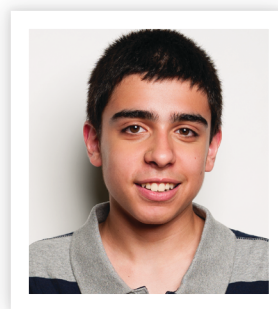

Registration Deadlines

Whether you're registering online or by mail, or plan to test in the United States or another country, you'll find the dates and deadlines you need to know about on the back of the *SAT and SAT Subject Tests Student Registration Booklet* or at sat.org/register.

TURN OVER ▶

More information can be found in the *Student Registration Booklet* or at sat.org/test-day-checklist.



818173

The SAT and SAT Subject Tests

Test Day Checklist

Before Test Day

Print your admission ticket

Sign in to your online College Board account to print your ticket at collegeboard.org/mysat. (Or, if you received your printed admission ticket in the mail, have it ready to bring on test day.) You must show your printed admission or waitlist ticket to get into the testing room. Electronic copies are not allowed. And remember to print and bring an updated admission ticket if you made changes to your registration.

Check your photo ID

You need to bring a photo ID that's valid (unexpired), original, government- or school-issued, and that bears your full legal name. The name on your ID must exactly match the name on your admission or waitlist ticket. If you travel to another country to test, you must provide a passport as identification. Additional ID requirements may apply—see the *Student Registration Booklet*, or visit sat.org/id.

Check the SAT Test Center Closings page

In case of bad weather, check sat.org/test-center-closings to make sure your test center is open. Check on Friday night and again on Saturday morning.

On Test Day

Bring these things

- Printed admission ticket
- Acceptable photo ID
- Two No. 2 pencils that have erasers
- An acceptable calculator (for the SAT or an SAT Subject Test in Mathematics)
- An acceptable CD player (for a Language with Listening Subject Test)

Don't bring these things

- Mobile phones, smartwatches, or wearable technology—these will be collected and held during testing.
- Other prohibited items—get a list at sat.org/test-day-checklist or see the *Student Registration Booklet*.

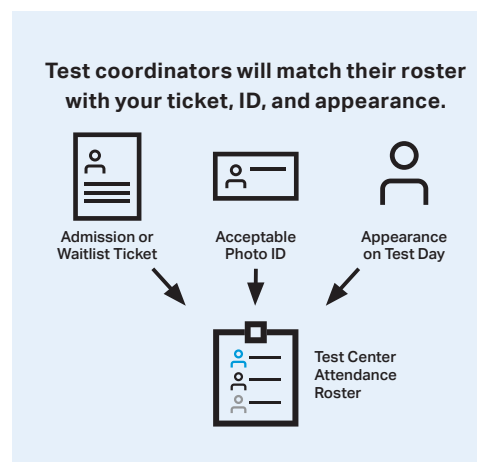

More information can be found in the *Student Registration Booklet* or at sat.org/test-day-checklist.